



**799  
BDWY**

**SOUTHWEST CORNER  
OF EAST 11TH STREET**





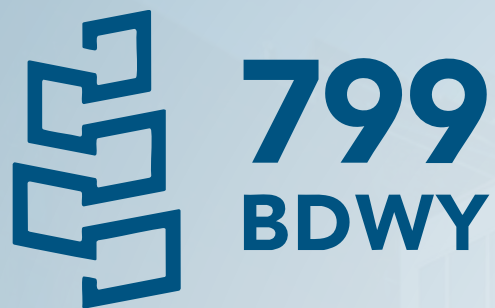

Ground Floor  
**7,189 SF\***

Ceiling Height  
**17 FT**

Frontage  
**51 FT**  
on Broadway

**142 FT**  
on E 11th St

\*Units can be combined

## Key Highlights

- Prime corner retail at the crossroads of Union Square and Greenwich Village
- Exceptional visibility with wraparound frontage on Broadway and East 11th Street
- Surrounded by dense foot traffic, transit access, and destination dining
- Positioned beneath a newly developed office building
- Flexible retail layouts suited for neighborhood-driven, service-oriented uses

## Proposed Ground Floor Divisions

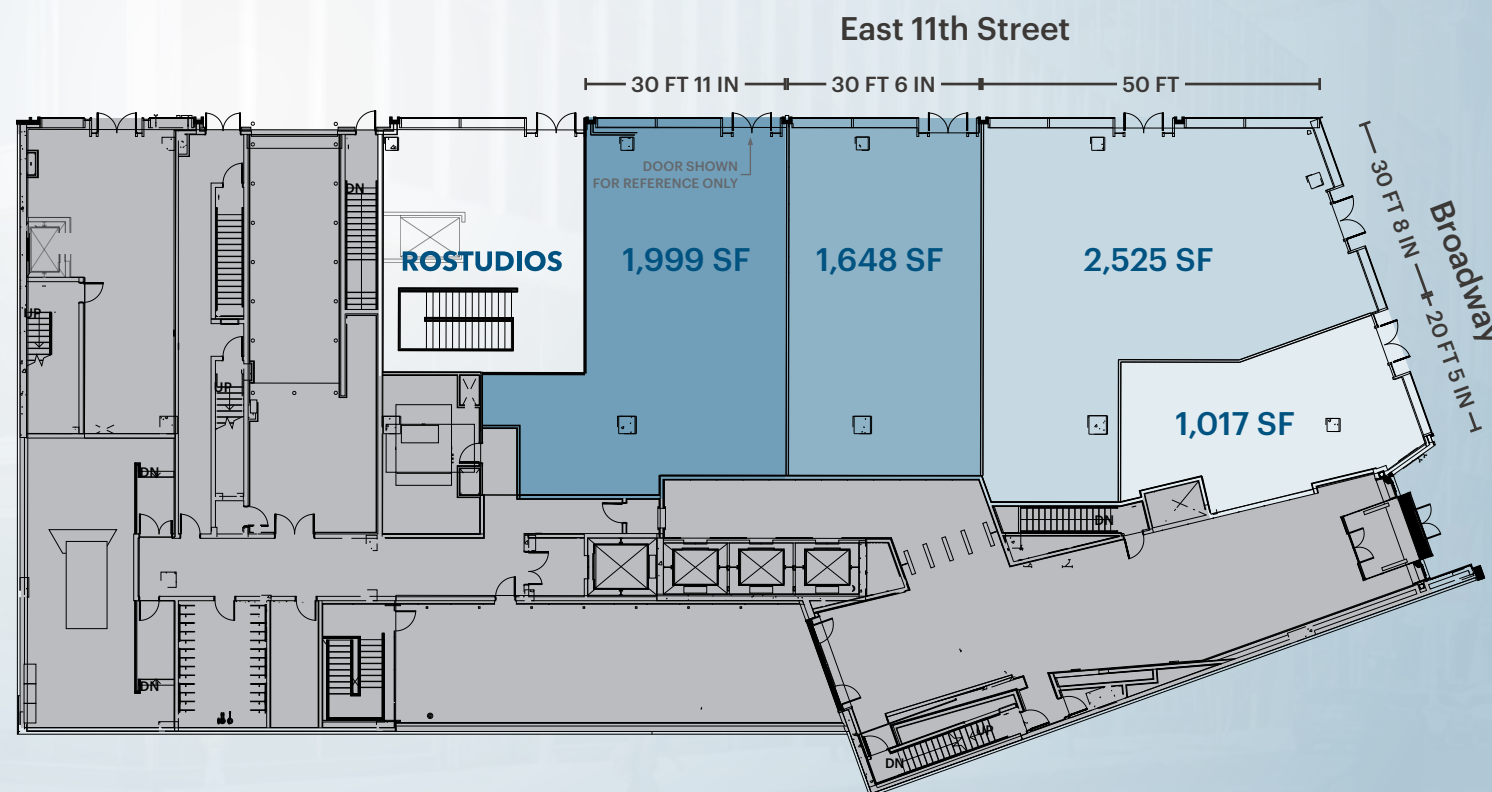



## AREA DEMOGRAPHICS

0.5 Mile Radius from 799 Broadway



59,965

Total  
Population



\$263,617

Avg Household  
Income



126,848

Daytime  
Population



103,481

Daytime Population  
Workers



85,097

Employees



6,103

Businesses







## Key Drivers of High-Volume Retail Activity

40K

Daily Visitors

380K

Average Daily Weekday Trips

436K

Annual Lyft Citi Bike Riders



22,000,000+

Annual Riderships

14th Street - Union Square Subway

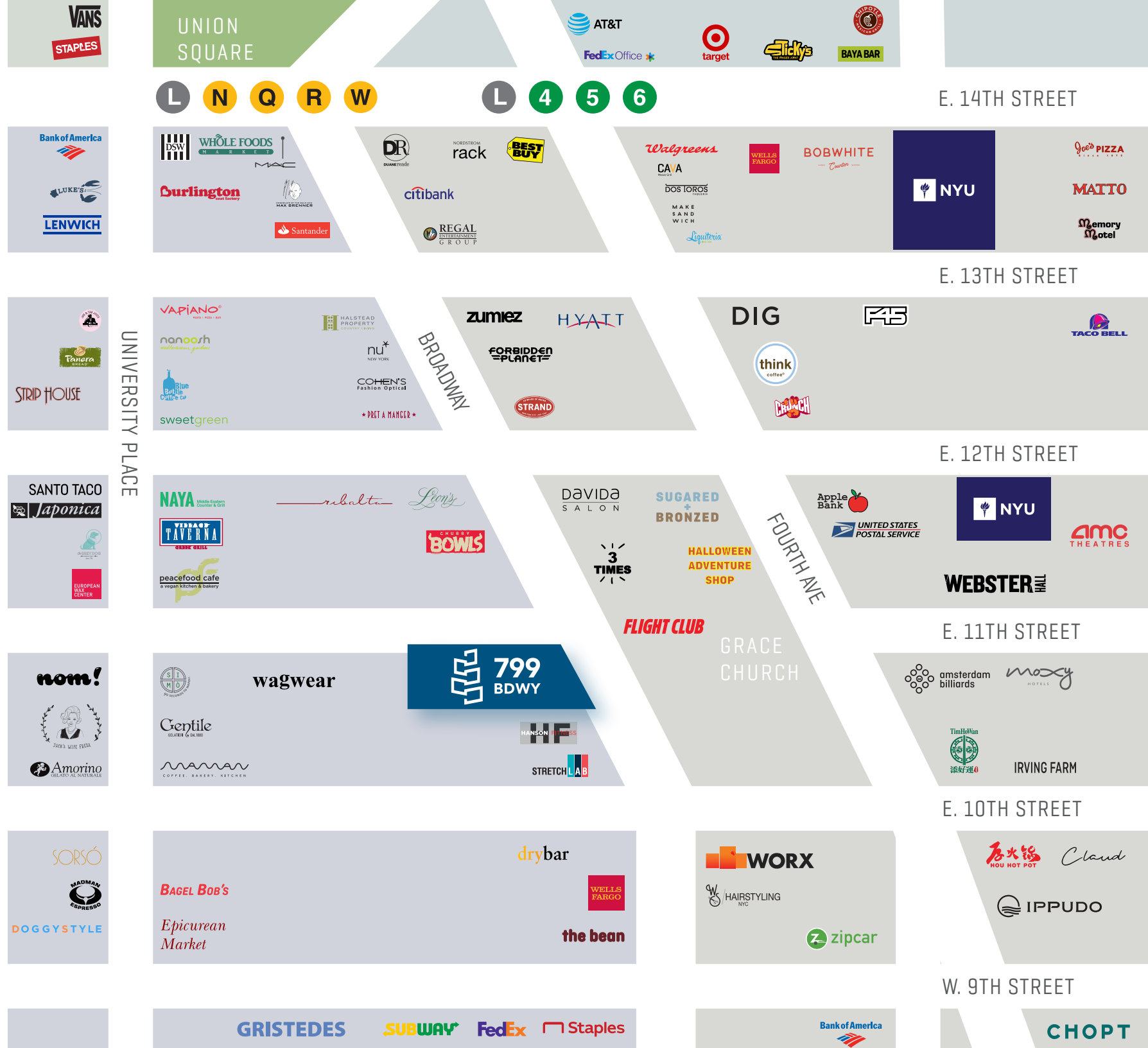



**799  
BDWY**

**799 BROADWAY**  
SOUTHWEST CORNER OF EAST 11TH STREET

For more information, please contact our exclusive agents

Steven E. Baker  
212-792-2636  
stevenb@rtl-re.com

Daniyel Cohen  
212-792-2610  
dcohen@rtl-re.com

Justin Geffner  
212-792-2625  
jgeffner@rtl-re.com



RTL Partners LLC Licensed Real Estate Brokers  
655 Third Avenue, 24th Floor | New York, NY 10017  
T 212.792.2600 | F 212.792.2660 | rtl-re.com

ALTHOUGH ALL INFORMATION REGARDING PROPERTY FOR SALE, RENTAL OR FINANCING IS FROM SOURCES DEEMED RELIABLE SUCH INFORMATION HAS NOT BEEN VERIFIED, AND NO EXPRESS REPRESENTATION IS MADE NOR IS ANY TO BE IMPLIED AS TO THE ACCURACY THEREOF, AND IT IS SUBMITTED SUBJECT TO ERRORS, OMISSIONS, CHANGE OF PRICE, RENTAL OR OTHER CONDITIONS, PRIOR SALE, LEASE OR FINANCING, OR WITHDRAWAL WITHOUT NOTICE.