

46-06

Eleventh Street

QUEENS NY, 11101
LONG ISLAND CITY

RETAIL FOR LEASE



retl

46-06

Eleventh Street

Queens, NY 11101 | Long Island City

SPACE A (approx.)

Ground Floor Corner:
Ceiling Heights:
Frontage (wraparound):

858 SF
11 FT
77 FT

SPACE B (approx.)

Ground Floor:
Ceiling Heights:
Frontage:

5,505 SF
12 FT
30 FT

POSSESSION

Immediate

ASKING PRICE

Upon Request

COMMENTS

- At the base of a 59-unit luxury residential development
- HVAC units installed in both spaces
- Steps from Jackson Avenue, Vernon Boulevard Subway Station and Murray Playground

NEIGHBORS

Fifth Hammer Brewing Company, Bianco Latte Bakery, Murray Playground, Trader Joe's, Bond Vet, Blend LIC, The Gutter Bar, and many more

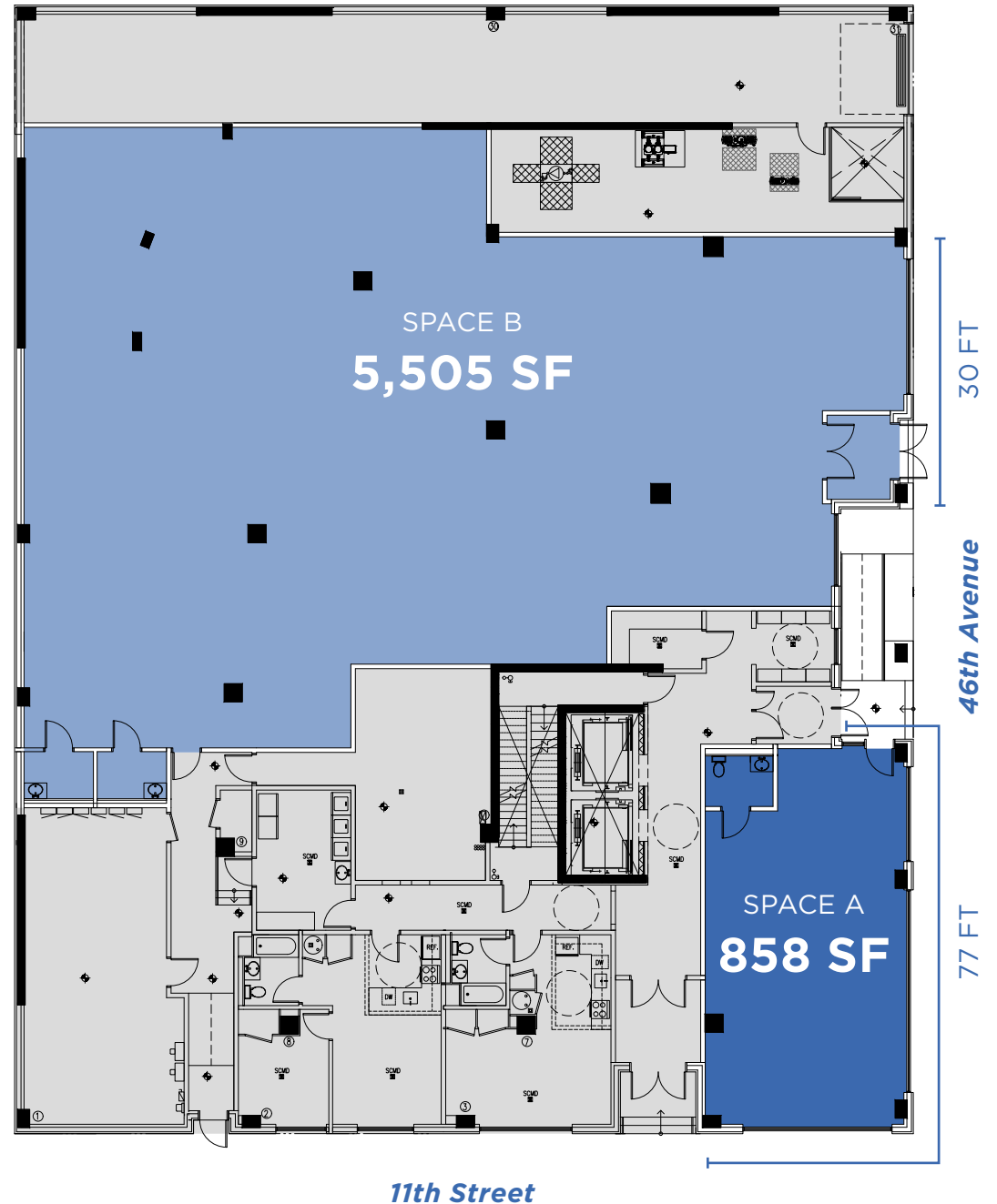

HOTEL

Existing Q1 2025

59 7,000+
Hotels Rooms

Under Construction

14 1,230+
Hotels Rooms

RESIDENTIAL

Existing Q1 2025

34,000+
Units

Under Construction

13,000
Units

OFFICE

Existing Q1 2025

10M SF

Under Construction

3M SF

RETAIL

Existing Q1 2025

1.1M+ SF

Under Construction

400K SF



7,000+
Businesses



130K+
Employees



250+
Restaurants/Bars/Cafes



50K+
College Students



40+
Arts & Culture



8
Subway Lines



15
Bus Lines



74
Citibike Docks



5
Bridges

MAP OF NEARBY RETAIL



46-06

Eleventh Street

Queens, NY 11101 | Long Island City

FOR MORE INFORMATION PLEASE CONTACT
OUR EXCLUSIVE AGENTS:

Thomas Galo

212.792.2602

tgalo@rtl-re.com

Matthew Knispel

212.792.2609

mknispel@rtl-re.com



RTL Partners LLC, Licensed Real Estate Brokers

655 Third Avenue, 24th Floor | New York, NY 10017

T 212.792.2600 | F 212.792.2660 | rtl-re.com

ALTHOUGH ALL INFORMATION REGARDING PROPERTY FOR SALE, RENTAL OR FINANCING IS FROM SOURCES DEEMED RELIABLE SUCH INFORMATION HAS NOT BEEN VERIFIED, AND NO EXPRESS REPRESENTATION IS MADE NOR IS ANY TO BE IMPLIED AS TO THE ACCURACY THEREOF, AND IT IS SUBMITTED SUBJECT TO ERRORS, OMISSIONS, CHANGE OF PRICE, RENTAL OR OTHER CONDITIONS, PRIOR SALE, LEASE OR FINANCING, OR WITHDRAWAL WITHOUT NOTICE