

3335-3375 NEPTUNE AVENUE

CONEY ISLAND | NEW YORK, NY 11224



rtl

3335-3375 NEPTUNE AVENUE

CONEY ISLAND | NEW YORK, NY 11224

SIZE (approx.)

Ground Floor: 2,000 SF

FRONTAGE

40 Feet

CEILING HEIGHTS

12 Feet

POSSESSION

Immediate

COMMENTS

- Tremendous trafficked location in Coney Island / Seagate area
- Food and cooking allowed
- Heavy residential / family area
- 872 apartments within the complex / plus Seagate

NEIGHBORS

Key Food, Dunkin', Popeyes, USPS,
Family Dental, Citibank, T-Mobile

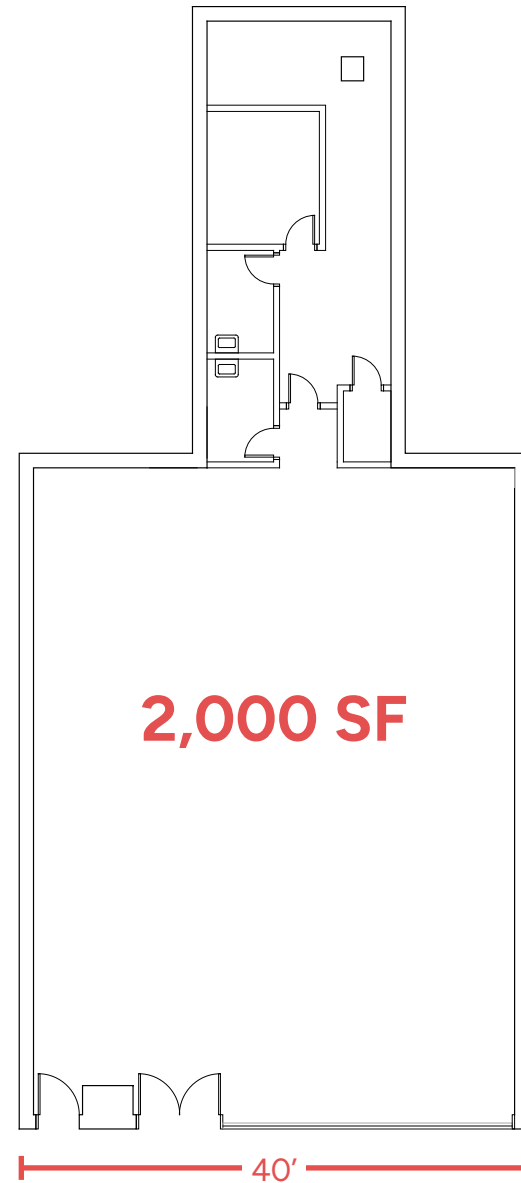

Neptune Avenue



RTL Partners LLC, Licensed Real Estate Brokers
655 Third Avenue, 24th Floor | New York, NY 10017
T 212.792.2600 | F 212.792.2660 | www.rtl-re.com

ALTHOUGH ALL INFORMATION REGARDING PROPERTY FOR SALE, RENTAL OR FINANCING IS FROM SOURCES DEEMED RELIABLE SUCH INFORMATION HAS NOT BEEN VERIFIED, AND NO EXPRESS REPRESENTATION IS MADE NOR IS ANY TO BE IMPLIED AS TO THE ACCURACY THEREOF, AND IT IS SUBMITTED SUBJECT TO ERRORS, OMISSIONS, CHANGE OF PRICE, RENTAL OR OTHER CONDITIONS, PRIOR SALE, LEASE OR FINANCING, OR WITHDRAWAL WITHOUT NOTICE

For more information, please contact exclusive agent:

Hal Shapiro

212.792.2623

hal@rtl-re.com