



MIDTOWN EAST

NY 10017

311

EAST 45TH ST

1,585 SF

GROUND FLOOR

rcl

TFC

3



EAST 45TH ST

RETAIL

MIDTOWN EAST

311 East 45th Street Btwn 1st & 2nd Avenues | New York, NY 10017

Ground Floor	Frontage	Ceiling Heights
1,585 SF	13 FT	14 FT

Notes

- Turnkey restaurant space & immediate possession
- Surrounded by dense office & residential area
- All uses considered
- Just off of busy Second Avenue
- Only steps from Grand Central & United Nations Headquarters
- Blade sign available
- Neighbors include United Nations, Pennylane Coffee, Club Pilates, Zara Terrace, Sparks Steak House, CHIRP, Barnea Bistro, Pietros

Transportation

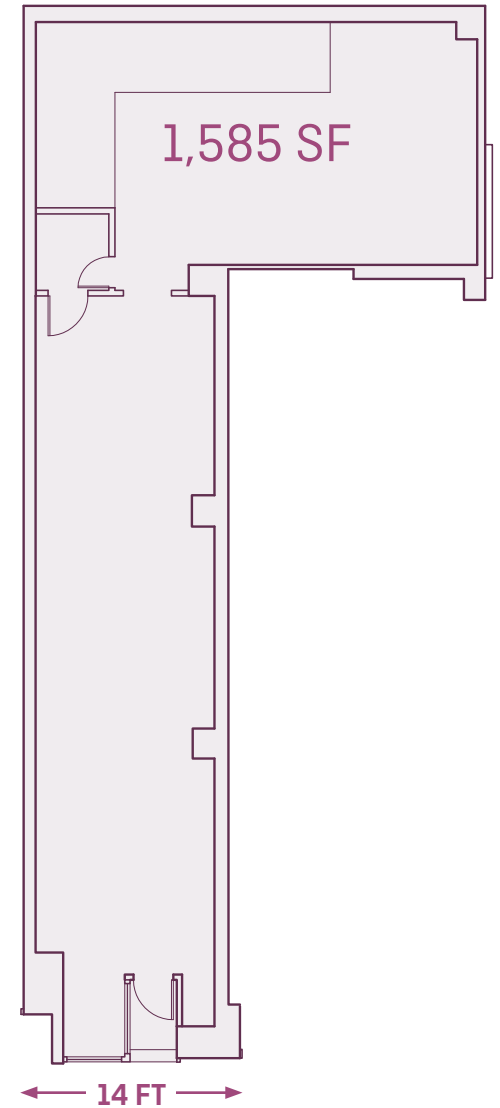
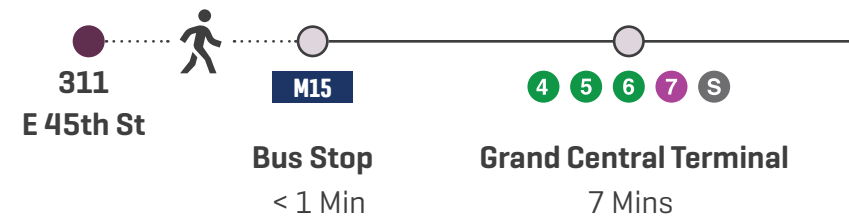

East 45th Street

Just a 7 min walk to
Grand Central Station



EAST 48TH STREET

Starbucks

Grant Thornton

MoneyGram

CVS pharmacy

One Dag Hammarskjöld Plaza

EAST 48TH STREET

DUNKIN' DONUTS

Hertz

verizon

DHL

Japan Society

EAST 47TH STREET

FedEx Office and Print Center

the Y

Lau Deboer Campus

Barnea Bistro

Bahamas Consulate

Dag Hammarskjöld Tower

EAST 47TH STREET

Two Dag Office Tower

Zara Terrace Mediterranean

50 United Nations Plaza

EAST 46TH STREET

Sparks Steakhouse

AKA United/Nations

Il Tinello

Chirp

Turtle Bay Liquors

Rosie Dunn's

Gourmet 45

Perfect Pint

Herbs

HR Block Thai Bistro

Midtown Shop

Basics Plus

EAST 46TH STREET

Shero Nail Salon

Wireless Warehouse

Club Pilates

Penny Lane Coffee

311 EAST 45TH ST

Kaoru

Turkish Consulate

EAST 45TH STREET

MTC KITCHEN

Pickler Sandwich

45 Deli

Essence Nail & Spa

Ermina's Market

DUANERead

EAST 45TH STREET

La Trattoria Pizza

Matto Espresso

Uganda House

United Nations Plaza

Keats Bar

Aji Sushi

SUBWAY

Ambassador Grill

EAST 44TH STREET

Pain

ups

Bento Sushi

Vino 43 Wine & Spirits

TD Bank

Toraji

Hampton

Grand Central

Mexican Palace

Johns Coffee Shop

EAST 44TH STREET

Flynn Stoned

REMI's

Church Center of the United Nations

EAST 43RD STREET

STAPLES

SUSHI YASUDA

CHASE

Bank of America

citi

Osteria Laguana

Patsy's Pizza

EAST 43RD STREET

Chelsea Bagel

DUNKIN' DONUTS

[solidcore]

Tudor City

EAST 42ND STREET

GAP

WESTIN HOTELS & RESORTS

OCEANFIRST BANK

★ PRET A MANGER ★

EAST 42ND STREET

GRAND CENTRAL STATION

4 5 6 7 S

67,000,000 passengers a year

THIRD AVENUE

SECOND AVENUE

FIRST AVENUE

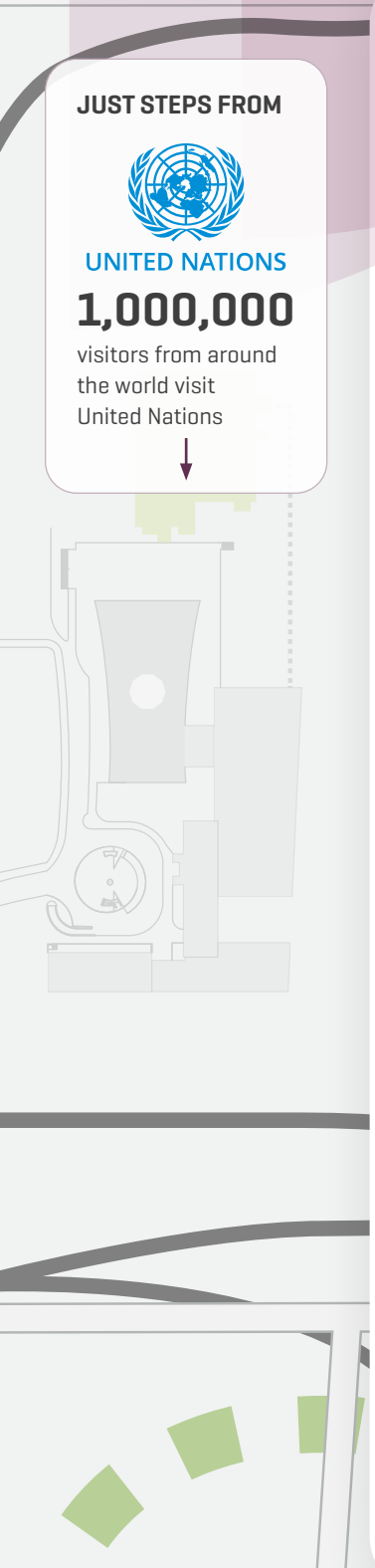

JUST STEPS FROM



UNITED NATIONS

1,000,000

visitors from around the world visit United Nations

311

EAST 45TH ST

For more information, please contact our exclusive agents

Steven E. Baker
 (212) 792-2636
 stevenb@rtl-re.com

Daniyel Cohen
 (212) 792-2610
 dcohen@rtl-re.com

Thomas Galo
 (212) 792-2602
 tgalo@rtl-re.com



RTL Partners LLC, Licensed Real Estate Brokers
 655 Third Avenue, 24th Floor New York, NY 10017 | 212 792 2600 | www.rtl-re.com

ALTHOUGH ALL INFORMATION REGARDING PROPERTY FOR SALE, RENTAL OR FINANCING IS FROM SOURCES DEEMED RELIABLE SUCH INFORMATION HAS NOT BEEN VERIFIED, AND NO EXPRESS REPRESENTATION IS MADE NOR IS ANY TO BE IMPLIED AS TO THE ACCURACY THEREOF, AND IT IS SUBMITTED SUBJECT TO ERRORS, OMISSIONS, CHANGE OF PRICE, RENTAL OR OTHER CONDITIONS, PRIOR SALE, LEASE OR FINANCING, OR WITHDRAWAL WITHOUT NOTICE.