

30 THIRD AVENUE

EAST VILLAGE
NEW YORK, NY 10003



30 THIRD AVENUE

NEW YORK, NY 10003

| NORTHWEST CORNER OF EAST 9TH STREET |

SIZE (approx.)

Ground Floor: 1,150 SF

FRONTAGE

30 Feet of wraparound frontage

POSSESSION

Immediate

ASKING PRICE

Upon Request

COMMENTS

- Prime corner directly across from Shake Shack
- Just steps from the Astor Place subway station

NEIGHBORS

UPS, The Smith, Little Ruby's Cafe, CVS, Wegmans, Life Time Fitness, The Bean

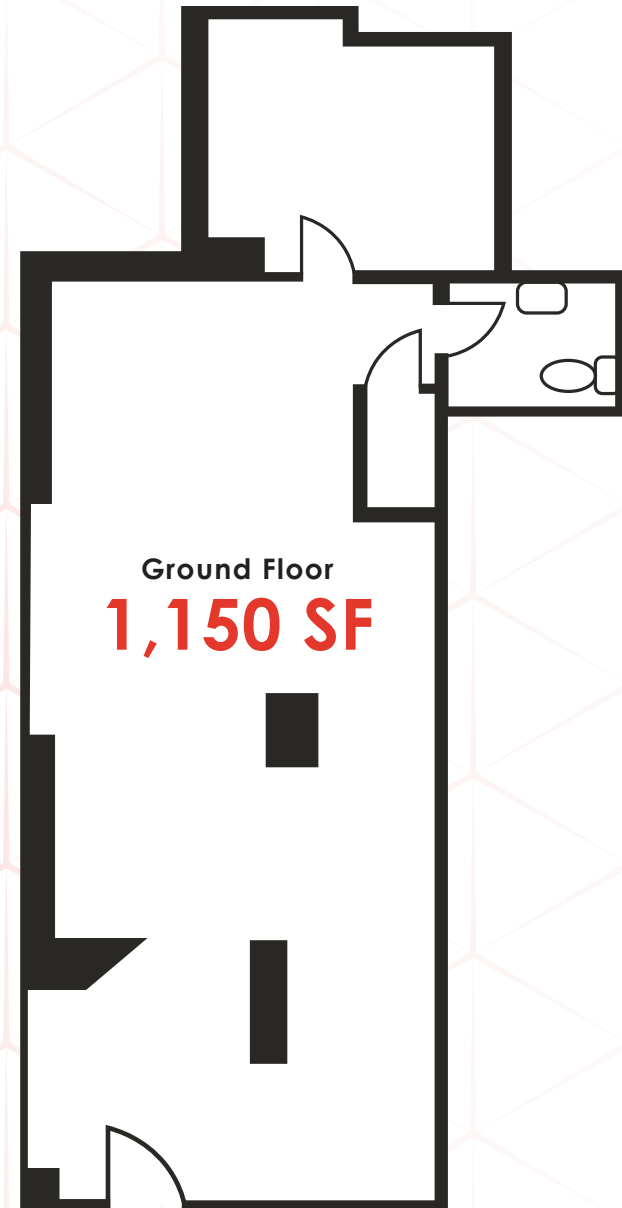

RTL Partners LLC, Licensed Real Estate Brokers
655 Third Avenue, 24th Floor | New York, NY 10017
T 212.792.2600 | F 212.792.2660 | www.rtl-re.com

ALTHOUGH ALL INFORMATION REGARDING PROPERTY FOR SALE, RENTAL OR FINANCING IS FROM SOURCES DEEMED RELIABLE SUCH INFORMATION HAS NOT BEEN VERIFIED, AND NO EXPRESS REPRESENTATION IS MADE NOR IS ANY TO BE IMPLIED AS TO THE ACCURACY THEREOF, AND IT IS SUBMITTED SUBJECT TO ERRORS, OMISSIONS, CHANGE OF PRICE, RENTAL OR OTHER CONDITIONS, PRIOR SALE, LEASE OR FINANCING, OR WITHDRAWAL WITHOUT NOTICE

For more information, please contact exclusive agents:

Charles Rapuano

212.792.2658

charles@rtl-re.com

Steven E. Baker

212.792.2636

stevenb@rtl-re.com